

Widecombe Way Hampstead Garden Suburb, £1,400,000

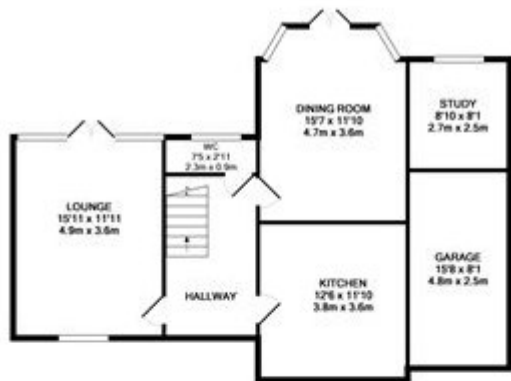

GROUND FLOOR
APPROX. FLOOR
AREA 771 SQ. M.
(830 SQ. FT.)

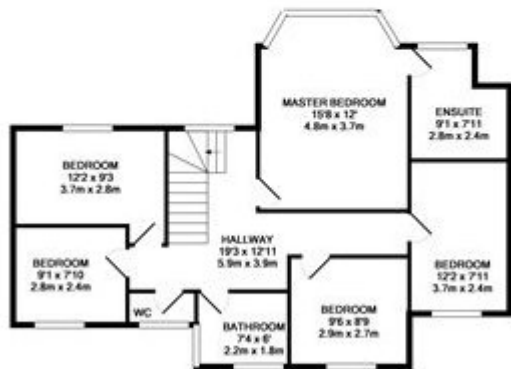

FIRST FLOOR
APPROX. FLOOR
AREA 74.8 SQ. M.
(809 SQ. FT.)

TOTAL APPROX. FLOOR AREA 1520 SQ. M. (1639 SQ. FT.)
While every attempt has been made to ensure the accuracy of the floor plan contained here, measurement of floors, windows, rooms and any other items are approximate and no responsibility is taken for any error, omission, or misstatement. This plan is for illustrative purposes only and should be used as such by any prospective purchaser. The services, systems and appliances shown have not been tested and no guarantee as to their operability or efficiency can be given.
Made with Metropix (2008)