

# Belsize Court, Wedderburn Road, Belsize Park

## £938,000 Share of Freehold

---

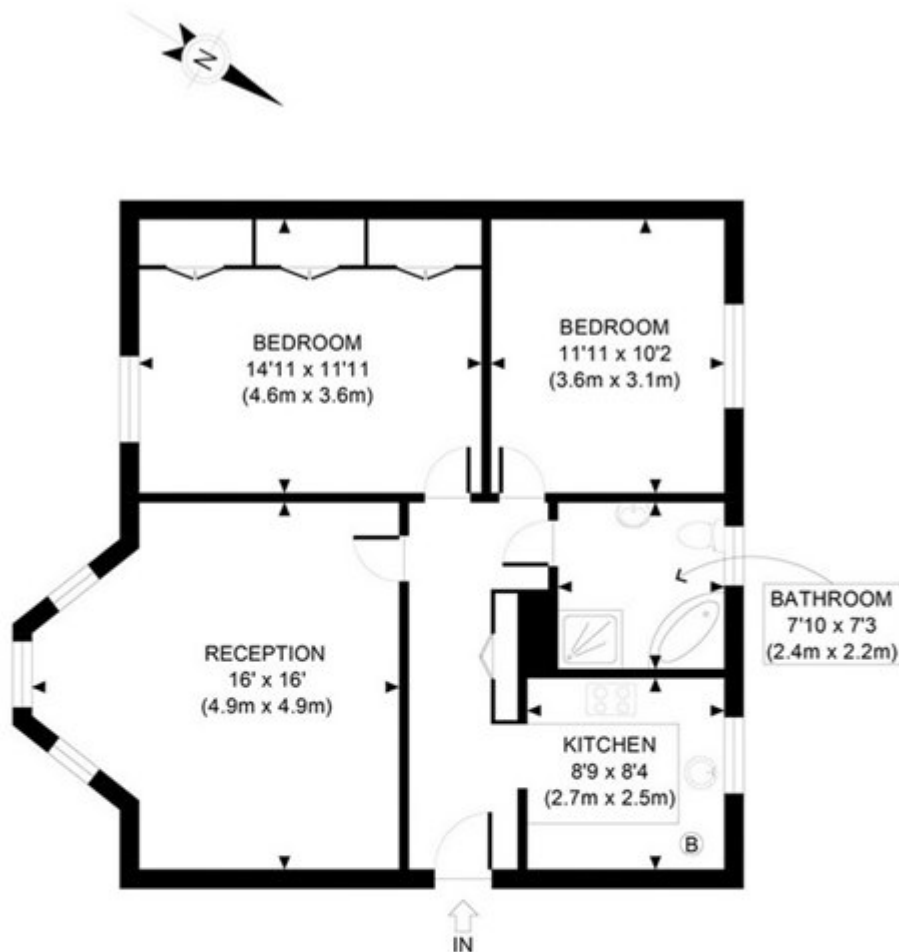

FIRST FLOOR  
GROSS INTERNAL  
FLOOR AREA 794 SQ FT

APPROX. GROSS INTERNAL FLOOR AREA 794 SQ FT / 74 SQM

Ref:

Copyright **photoplan**

Disclaimer: Floor plan measurements are approximate and are for illustrative purposes only.  
While we do not doubt the floor plan accuracy and completeness, you or your advisors should  
conduct a careful, independent investigation of the property in respect of monetary valuation