

Kingsland Road, London

£380,000

Approx Gross Internal Area
74 sq m / 796 sq ft

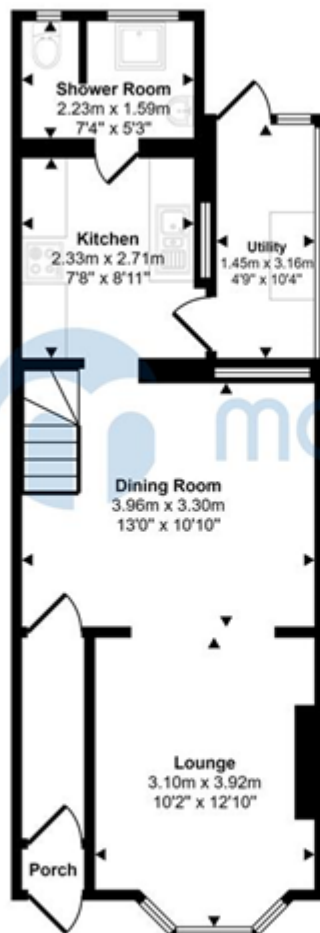

Ground Floor
Approx 46 sq m / 492 sq ft

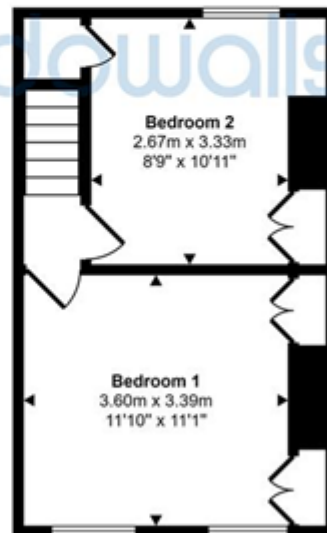

First Floor
Approx 28 sq m / 303 sq ft

This floorplan is only for illustrative purposes and is not to scale. Measurements of rooms, doors, windows, and any items are approximate and no responsibility is taken for any error, omission or mis-statement. Icons of items such as bathroom suites are representations only and may not look like the real items. Made with Made Snappy 360.